



POLYFIL-3

TIG

Cold Wire Feeder for orbital welding



POLYSOUDE
THE ART OF WELDING

Polyfil-3

External Wire feeder

Cold wire feeder for orbital TIG welding.

Advantages

- ▶ Compatible with all series of Polysoude power sources and welding heads
- ▶ Closed loop regulation to ensure precise wire feeding
- ▶ Directly controlled by the power source, no external power supply is required
- ▶ Four adjustable wire rollers
- ▶ Closed, protected wire spool
- ▶ Carry Handle



Wire liner



Drive mechanism

Technical Specification

Compatible for wire spool Diameter and weight	15 kg / 300 mm 5 kg / 200 mm
Wire diameter	0,8 mm and 1,0 mm (other dia. on request)
Wire feed speed (valid for all Polysoude™ power sources)	min 150 mm/min max 2552 mm/min
Cable length	9 m
Dimensions L x W x H	640 x 310 x 430 mm
Weight excluding wire spool	16 kg

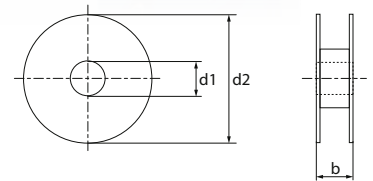

Wire spool Dimensions in mm		
	5 kg	15 kg
b	57	105
d1	52	52
d2	200	300

Options and accessories

- Adjustable wire guide
- Wire liner
- Wire drive pressure rollers for different wire diameters